

Fittings, Unions

Main Features	
Application	distribution of cold, hot and heating water
Working fluid	water, drinking water and antifreeze fluid for heating systems, heat pumps and solar thermal systems
Technical Data	
Max. working pressure	16 bar (straight union flat sealing, union); 6 bar (union Cu)
Max. working temperature	160 °C (union and Cu); 95 °C
Materials	
Union housing	brass CW617N
Union nut	brass CW617N
Sealing in straight union flat sealing	NBR
Union sealing	AFM34
Securing ring in union	steel wire ČSN 426450
Codes	
15805	straight union flat sealing G 1" F x G 1" F
15822	straight union flat sealing G 5/4" F x G 5/4" F
16234	pump union G 6/4" Fu x G 5/4" F
19058	pump union G 6/4" Fu x G 5/4" M
5597	pump union G 6/4" Fu x G 1" F
16227	pump union G 2" Fu x G 5/4" F
15795	union G 5/4" Fu x G 1" F
15693	union G 3/4" Fu x G 3/4" M
15692	union G 3/4" Fu x G 3/4" F
15695	union G 1" Fu x G 1" M
15694	union G 1" Fu x G 1" F
18797	union G 1" Fu x G 1" F
18653	union G 1"Fu x G 1"F with check valve
17920	union G1" Fu x G 5/4" F
17794	compression fitting Cu 18 x Cu 18
17797	compression fitting Cu 18 x G 1/2" M
7629	compression fitting Cu 22 x Cu 22
13695	compression fitting Cu 22 x G 3/4" M
13391	compression fitting Cu 28 x G 1" M
17090	compression fitting Cu 28 x G 5/4" M
13394	compression fitting Cu 28 x Cu 28
6765	union braze adaptor, Cu 28 x G 5/4" Fu

Fittings, Unions

Dimensions – straight union flat sealing, pump union, union

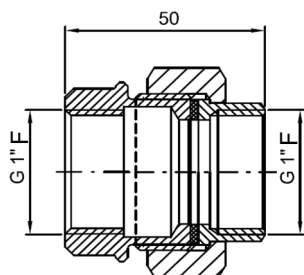

code 15805
weight: 290 g

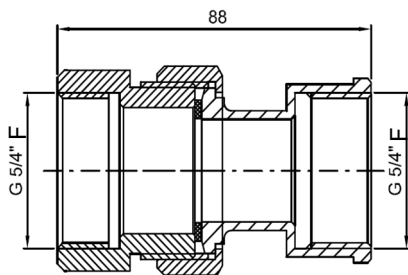

code 15822
weight: 510 g

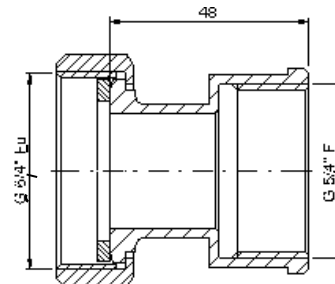

code 16234
weight: 260 g

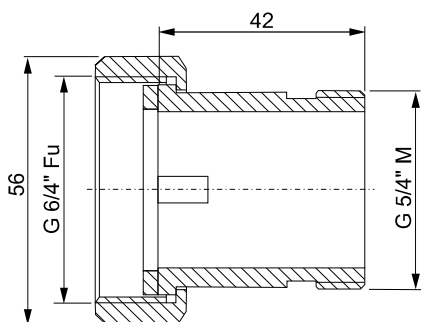

code 19058
weight: 240 g

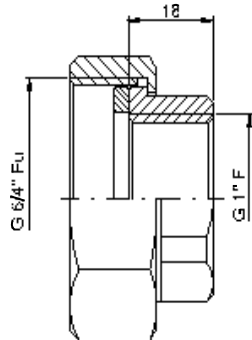

code 5597
weight: 185 g

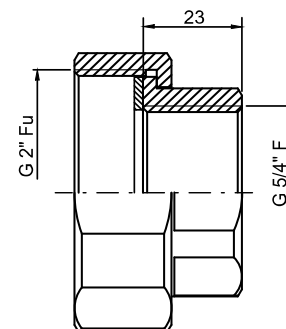

code 16227
weight: 300 g

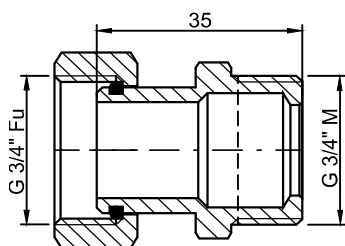

code 15693
weight: 95 g

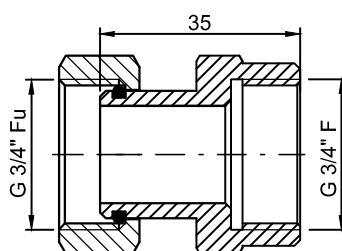

code 15692
weight: 120 g

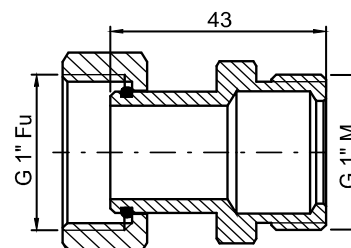

code 15695
weight: 160 g

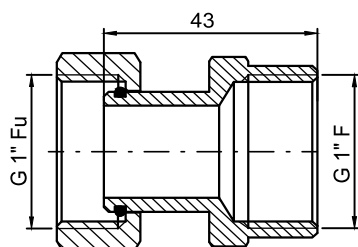

code 15694
weight: 160 g

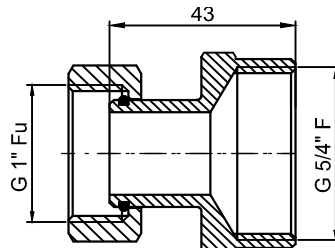

code 17920
weight: 220 g

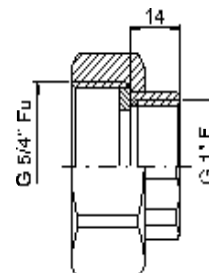

code 15795
weight: 150 g

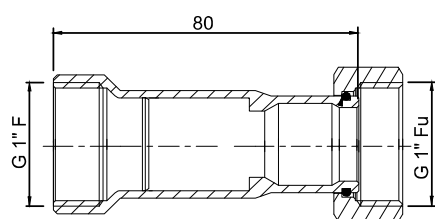

code 18797
weight: 190 g

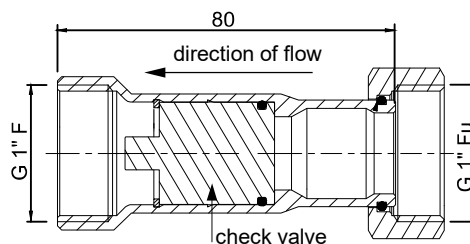

code 18653
weight: 200 g

Fittings, Unions

Dimensions - compression fittings, Cu

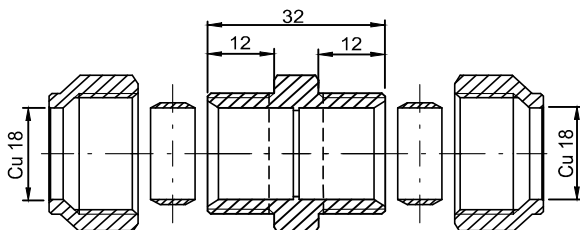

code 17794
weight: 110 g

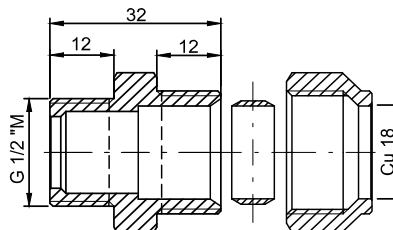

code 17797
weight: 80 g

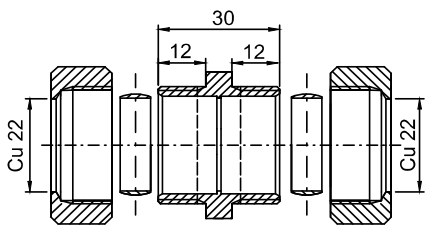

code 7629
weight: 150 g

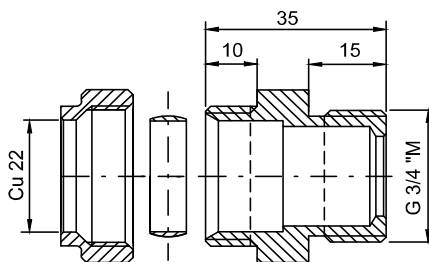

code 13695
weight: 120 g

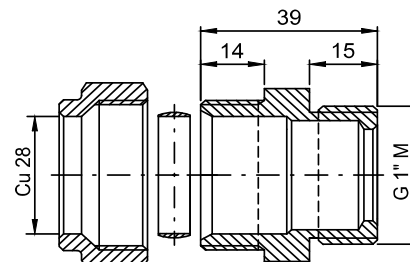

code 13391
weight: 190 g

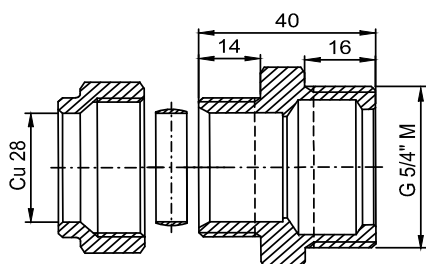

code 17090
weight: 260 g

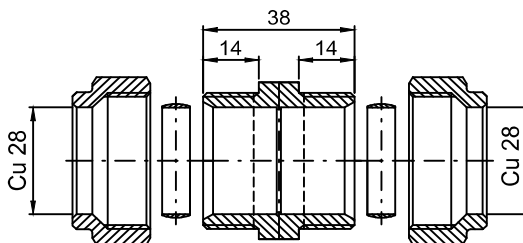

code 13394
weight: 265 g

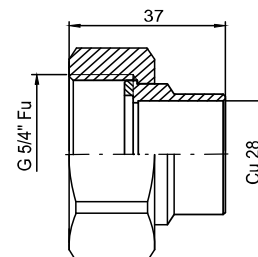

code 6765
weight: 530 g