

Installation and Operating Manual



Note:

- Installation only by persons with electro technical knowledge and experience.
- Use cable which is suitable for outdoor use (if mounted outside).
- Do not use a dimmer to operate this luminaire

1. Ensure the main power source is turned off.
2. Drill two holes at the desired height where the LED fixture should hang. Use the two designated points from the fixture as spacing between the holes.
3. Connect the luminaire to the mains supply. Fix the luminaire to the suitable position.
4. Activate the Power source.

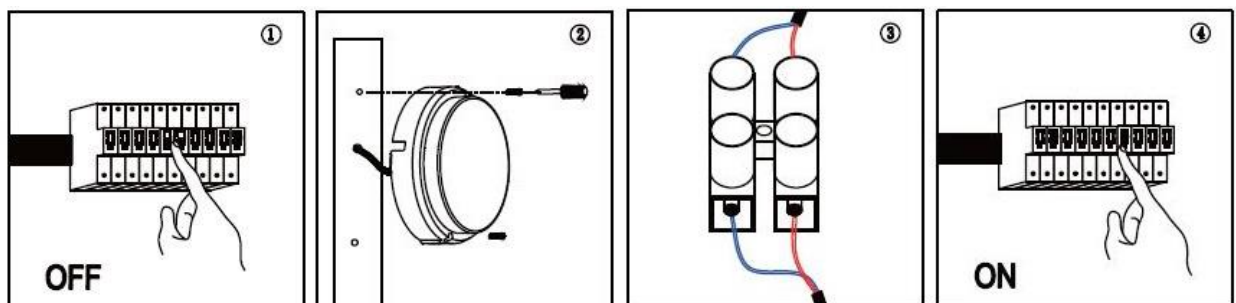

Specifications

	Shape	Power	Lumen output	Color temp.	Dimensions	Beam angle	Input voltage	Light tipe
LEDBHON-1812-WL	Oval	12W	900lm	4000K	178x86x50	120°	220-240V AC	Natural
LEDBHOC-1812-WL	Oval	12W	900lm	6000K	178x86x50	120°	220-240V AC	Cold
LEDBHON-2018-WL	Oval	18W	1350lm	4000K	202x99x50	120°	220-240V AC	Natural
LEDBHOC-2018-WL	Oval	18W	1350lm	6000K	202x99x51	120°	220-240V AC	Cold
LEDBHRN-1612-WL	Round	12W	900lm	4000K	D160x50	120°	220-240V AC	Natural
LEDBHRC-1612-WL	Round	12W	900lm	6000K	D160x51	120°	220-240V AC	Cold
LEDBHRN-1718-WL	Round	18W	1350lm	4000K	D175x50	120°	220-240V AC	Natural
LEDBHRC-1718-WL	Round	18W	1350lm	6000K	D175x51	120°	220-240V AC	Cold

General safety instructions

Please read the operating instructions for the LED luminaire before use. The operating instructions are part of the product. They contain important notes on start-up and handling of the device. Always keep the enclosed operating instructions so as to be able to look up information. They must be enclosed when passing the device on to third parties.

Safety precautions

The user must observe the safety notes and warnings in order to maintain this status and to ensure safe operation. Please read the operating instructions before start up.

Never attempt to open the device other than described in this manual. The LED luminaire cannot be repaired; this part must be immediately disposed in case of a defect. Ensure sufficient ventilation of the device. Never cover it during operation. Do not install in reach of children or animals.

Any other use of the device than described above can damage the product or endanger the user due to e. g. short-circuits, fire or an electric shock. The entire product may not be modified or adapted.

These safety notes must be observed in all cases!

Any warranty claim is void in the case of damages caused by non-observance of these operating instructions. We are not liable for consequential damages or for damages to property or persons caused by non-observance of the safety notes and improper operation of the device.

Safe operation is not possible anymore, if:

- The LED luminaire has visible damages,
- The LED luminaire does not work anymore

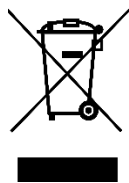

Waste electrical and electronic equipment are a special waste category, collection, storage, transport, treatment and recycling are important because they can avoid environmental pollution and are harmful to health. Submitting waste electrical and electronic equipment to special collection centers makes the waste to be recycled properly and protecting the environment. Do not forget! Each electric appliance that arrives at the landfill, the field, pollutes the environment!



Importer & distributor:

SC VITACOM ELECTRONICS SRL

CIF: RO 214527

Tel. 0264-438401*

sales@vitacom.ro, www.vitacom.ro